

A large-format Epson Stylus Pro printer is shown in a light grey, semi-transparent view. The printer is long and horizontal, with a control panel on the left side. The paper path is visible, showing the paper being processed. The printer is mounted on a stand with blue drawers. The Epson logo is visible on the front panel. The background is a light blue gradient.

EPSON®

EPSON Stylus® Pro 7600/9600  
Quick Reference Guide

- 1** Slide the removable paper stop off the left end of the spindle.

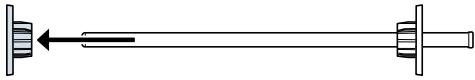

To use a 3-inch roll paper core, attach the gray adapters to the paper stops at each end. See your *Printer Guide* for details.

- 2** Position the roll paper as shown, then slide it onto the spindle.

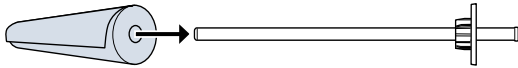

- 3** Slide the removable paper stop back onto the spindle and insert it firmly into the end of the roll.

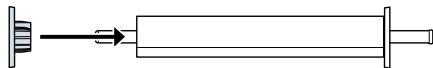

- 4** Open the roll paper cover on the printer.

- 5** Place the roll paper in the printer as shown. (The white end of the spindle goes on the right.)

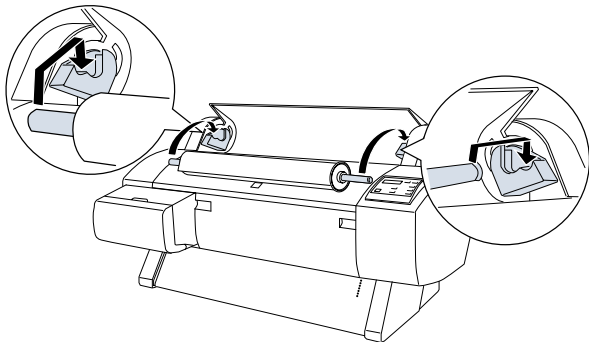

- 6** Make sure the printer is turned on, then press the Paper Source button until the Roll Auto Cut light comes on.



To avoid feeding excess paper, make sure you don't select **Sheet** when you're using roll paper.

- 7** Move the paper lever to the released position.

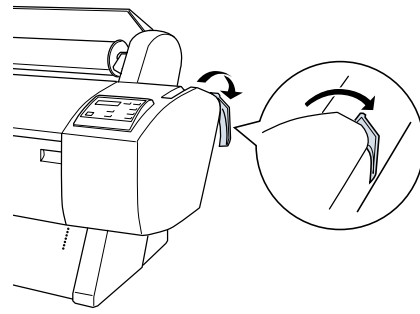

- 8** Feed the paper into the slot and pull it all the way through.

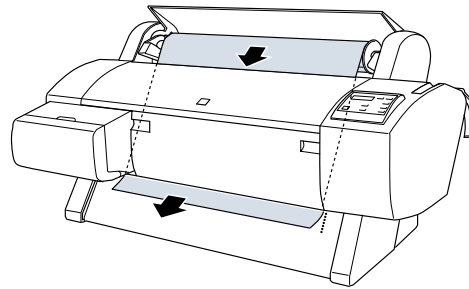

- 9** Turn the roll back to remove any slack. Then align the bottom edge of the paper with the row of holes, as shown.

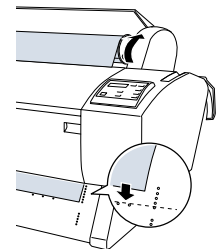

- 10** Return the paper lever to the locked position, then close the roll paper cover.

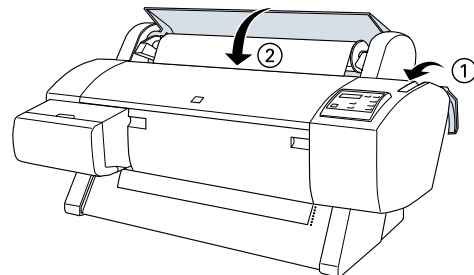

- 11** Press the Pause button. The paper feeds into the printing position automatically and READY appears on the control panel.

- 1 Make sure the printer is on and the roll paper cover is closed.
- 2 Press the **Paper Source** button until the **Sheet** light comes on.
- 3 Push the paper lever back to the released position.

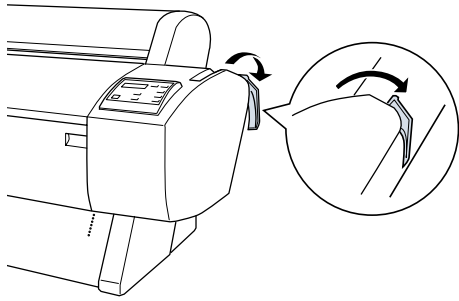

- 4 Feed the sheet into the paper slot. Make sure the right edge of the paper is straight and aligned with the scale on the roll paper cover.

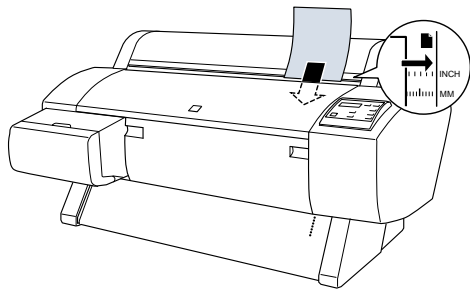

For a large sheet of paper, feed it so that it comes out below. Then align the edges of the sheet with the rows of holes as shown.

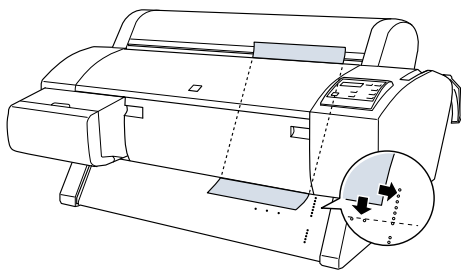

For heavy paper, you may need to increase the suction strength by pressing the ▲ button. This helps hold the paper in place during loading and printing.

For lightweight paper, decrease the suction by pressing the ▼ button.

- 5 Return the paper lever to the locked position.
- 6 Press the **PAUSE** button. The sheet feeds into the printing position automatically and **READY** appears on the control panel.



To avoid damaging the printer, never move the paper lever during printing, or while the **Operate** or **Pause** light is flashing.

- 7 Print your page. After it is finished, the sheet stays in the printer.
- 8 To remove your print, press the **Paper Feed** ▼ button.

## Printing on Posterboard

When you print on posterboard or other thick media (more than 19 mil thick), you should open the front cover before loading as described below.

- 1 Make sure the printer is on and the roll paper cover is closed.
- 2 Press the **Paper Source** button until the **Sheet** light comes on.
- 3 Push the paper lever back to the released position.

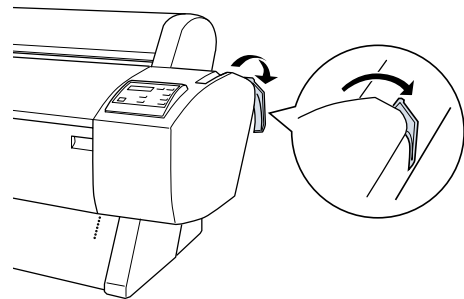

Continue ►

- 4** Open the front cover. (The cover has special tabs that act as paper supports when the cover is open.)

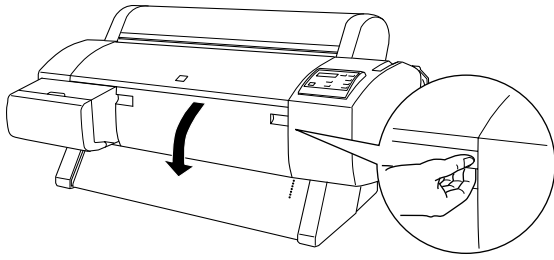

- 5** Feed the posterboard into the paper slot until it meets resistance.



**Note** If you're using stock more than 39 inches long, load it long edge first (in landscape orientation).

- 6** Align the board with the scale on the roll paper cover.

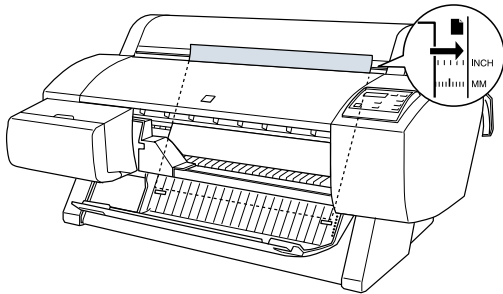

- 7** Return the paper lever to the locked position. Then close the front cover.

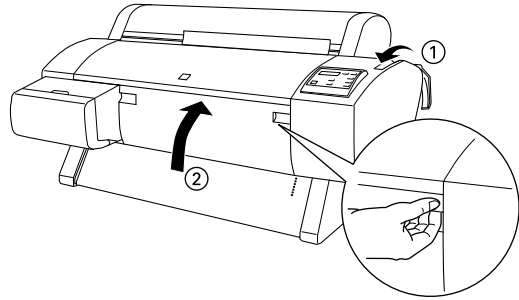

- 8** Press the **Pause** button. The board feeds into the printing position automatically and **READY** appears on the control panel.
- 9** Run your print job. After it is finished, the posterboard stays in the printer.

- 10** To remove the print, hold it and push the paper lever back to the released position.



**Caution** To avoid damaging the printer, never move the paper lever during printing, or while the **Operate** or **Pause** light is flashing.

If you notice banding or missing colors in your printouts, the print head may need cleaning. First print a nozzle check pattern to find out the condition of the print head. Then run a cleaning cycle, if necessary, and print another check pattern to test the results.

- 1 Load a sheet of coated ink jet paper (or roll paper) in the printer.

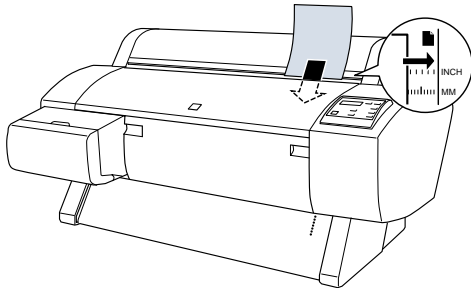

- 2 Press the SelecType button, then press the ▼ button so that TEST PRINT appears on the display.

- 3 Press the ► button twice, then press Enter. The nozzle check prints as shown:



If all the lines in the nozzle check are complete, with no missing dots or gaps, the print head doesn't need cleaning.

If the pattern is missing dots or lines, as shown below, you need to run a cleaning cycle.



- 4 Make sure all the Ink Out lights on the printer's control panel are off. If an Ink Out light is flashing or on, you need to replace the corresponding ink cartridge instead.

- 5 Press the Cleaning button and hold it for at least 3 seconds. The Pause light flashes as the printer cleans its print head. The cleaning cycle takes about a minute and does not use any paper.

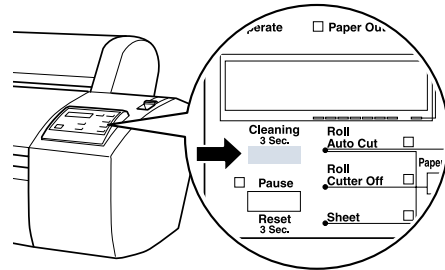

To avoid damaging the printer, don't turn it off until the cleaning cycle is finished and the **Pause** light has stopped flashing.

- 6 When the Pause light goes off, follow steps 1 through 3 to run another nozzle check to make sure the print head is clean.

## If You Notice Banding...

If you still see banding after running a cleaning cycle, you may need to align the print head as described in the *Printer Guide*.

Banding can also be caused by selecting the incorrect paper type in your printer software. Be sure to select the paper you're using in the EPSON printer software or in a third-party RIP. If your paper is not listed, you can use the printer's SelecType menu to create a custom paper type (see "Optimizing the Settings for Your Paper" in the *Printer Guide*).

Before you begin a large print job, you should check your ink levels. If one of your cartridges is low, you can replace it before you start. Or you can wait until the ink runs out, replace the cartridge, and then continue the job without any loss of print quality.

### Checking Ink Levels

The easiest way of checking ink levels is from the control panel.

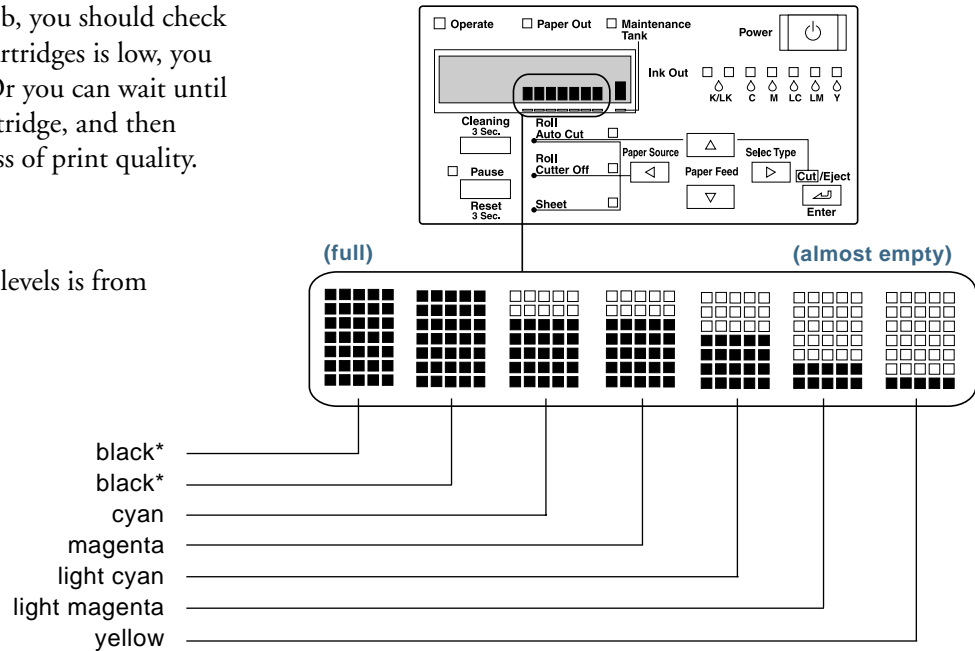

\* If your printer uses EPSON UltraChrome™ ink, the black ink cartridges may be either Photo Black, Matte Black, or Light Black. See your *Printer Guide* for more information on switching between black print modes.

### EPSON Photographic Dye™ ink

	110 ml
Black	T545100
Cyan	T545200
Magenta	T545300
Yellow	T545400
Light Cyan	T545500
Light Magenta	T545600

### EPSON UltraChrome ink

	110 ml	220 ml
Photo Black	T543100	T544100
Cyan	T543200	T544200
Magenta	T543300	T544300
Yellow	T543400	T544400
Light Cyan	T543500	T544500
Light Magenta	T543600	T544600
Light Black	T543700	T544700
Matte Black	T543800	T544800

### Replacing Ink Cartridges

When one of the Ink Out lights is flashing and INK LOW is displayed on the control panel, the corresponding cartridge is nearly empty. Make sure you have the correct replacement cartridge.

If you have a Stylus Pro 9600 that uses EPSON UltraChrome ink, you can install any combination of 110 ml and 220 ml cartridges. Unless you are planning to switch between black print modes (see your *Printer Guide* for details), be sure to replace the black ink cartridges with the same colors as you are currently using.

Continue ►

When one of the Ink Out lights stays on and INK OUT is displayed on the control panel, the cartridge is empty. To replace the cartridge, first make sure the printer is on.

- 1 Open the ink compartment cover.

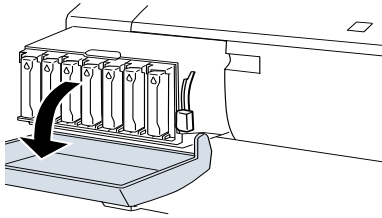

- 2 Raise the ink lever to the unlocked position.

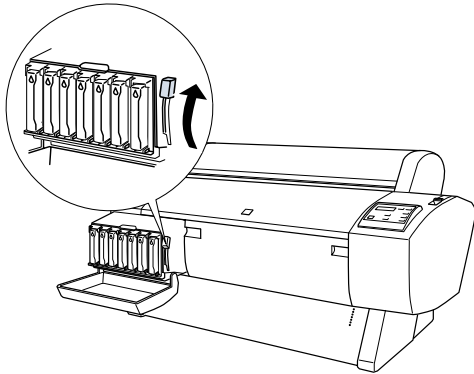

- 3 Remove the empty ink cartridge from the printer.

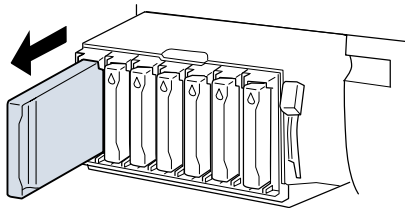

**Warning**



Do not shake the empty cartridge, or ink may escape. If ink gets on your hands, wash them thoroughly with soap and water. If ink gets in your eyes, flush them immediately with water.

- 4 Make sure the replacement cartridge is the correct color, and remove it from its package.

If you're using UltraChrome Ink, gently shake the cartridge before installing it.

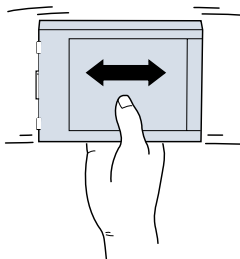

- 5 Hold the cartridge with the arrow mark pointing toward the printer. Then insert the cartridge into the slot. Don't force it.



If you can't insert the cartridge smoothly, you may have the wrong cartridge. Check the package and product code. If the Ink Out light remains on after installing the cartridge, it may not be inserted fully.

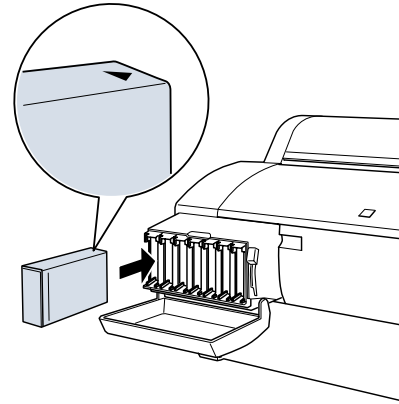

- 6 Return the ink lever to its locked position.

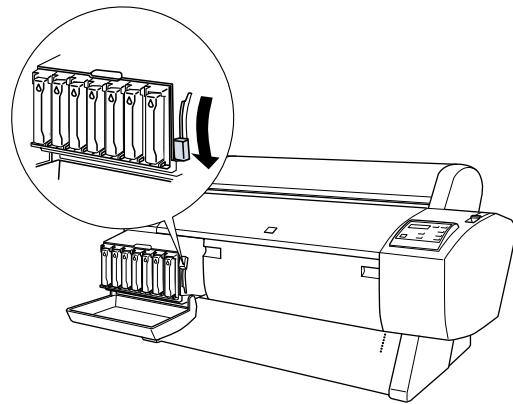

- 7 If you're using 110 ml cartridges, close the ink compartment cover. If you're using 220 ml cartridges, you'll have to leave the cover open.



If you see the message WRONG INK CARTRIDGE, you may have loaded an incorrect black ink cartridge for the black ink mode you're currently in, or a cartridge containing the wrong type of ink for your printer (Photographic Dye or UltraChrome). Remove any cartridges indicated by a red light on the control panel, and replace them with the correct cartridges.

## Replacing the Cutter Blade

If you notice that the paper isn't cut cleanly, you may need to replace the cutter blade. You can check its status as described below:

- 1 Press the **SelectType** button on the control panel, then press ▼ until you see **PRINTER STATUS**.
- 2 Press ►, then press ▼ until you see **SERVICE LIFE**.
- 3 Press ►, then press ▼ until you see **CUTTER**.

E\*\*\*\*\*F indicates a new cutter. If no stars are displayed, the cutter needs to be replaced.

Follow these steps to replace the cutter:

- 1 Press the **SelectType** button on the control panel, then press ▼ until you see **MAINTENANCE**.
- 2 Press ►, then press ▼ until you see **CUTTER REPL.**
- 3 Press ►, then press **Enter**. The carriage moves to the cutter replacement position.
- 4 Open the front cover. Hold down the side pin, as shown, then turn the latch to the right.

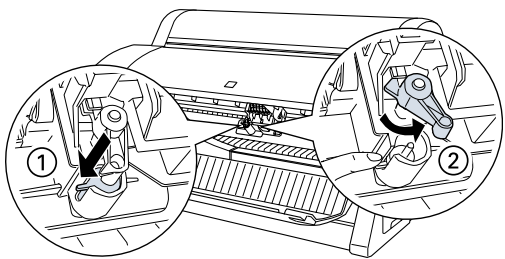

- 5 Carefully remove the cutter blade, being careful not to let the spring fly out.

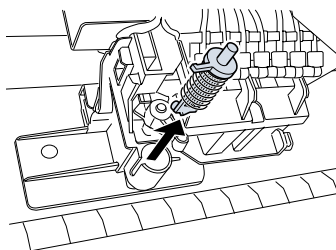

- 6 Insert the new cutter blade. Hold down its side pin and secure it with the latch.
- 7 Close the printer cover. The carriage returns to the home position and the cutter replacement is complete.

## Replacing the Maintenance Tank

The maintenance tank stores ink that gets flushed from the system during print head cleaning and other maintenance procedures. It is time to replace it when the **Maintenance Tank** light remains on. You can also check its status as shown below:

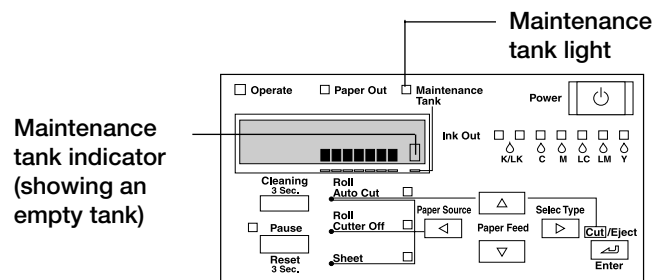

Follow these steps to replace the tank:

- 1 Turn on the printer. Wait until **READY** or **PAPER OUT** appears on the control panel.



Make sure the printer is on before you start.

- 2 Pull out the maintenance tank from the side of the printer.



Do not tip the tank, or ink may spill out.

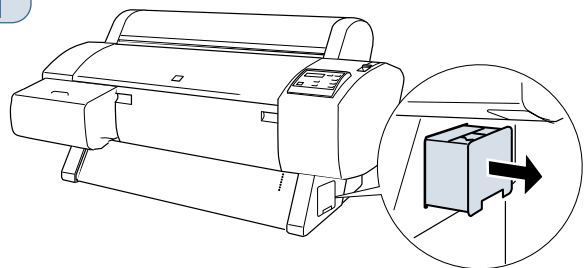

- 3 Insert the new tank.



## Status messages

These messages indicate normal phases of printer operation.

Message	Light	Explanation or response
READY	<b>Operate</b> light on	Printer is ready to print.
PRINTING	<b>Operate</b> light flashing	Printer is receiving data.
RESET	All lights flash briefly	Printer is resetting.
PRESS PAUSE BUTTON	<b>Pause</b> light on	Press the <b>Pause</b> button to continue.
WAIT	<b>Pause</b> light on	Printer is initializing, performing maintenance, or charging ink.
PAUSE	<b>Pause</b> light flashing	Printer is paused. To resume printing, press the <b>Pause</b> button.

## Error messages

For a complete list of error messages, see your *Printer Guide*.

Message	Light	Explanation	Response
INK LOW	<b>Ink Out</b> light(s) flashing	Ink cartridge(s) nearly empty (printing continues).	Replace ink cartridge(s) indicated by <b>Ink Out</b> light(s). See page 7.
INK OUT	<b>Ink Out</b> light(s) on	Ink cartridge(s) empty (printing stops).	Replace ink cartridges indicated by <b>Ink Out</b> light(s). See page 7.
LOAD ROLL PAPER LOAD SHEET PAPER	<b>Paper Out</b> light on	Paper source setting in print options is different from control panel.	Make sure the right paper is loaded and the paper source setting is the same on the control panel and print options.
MAINTENANCE REQ. <error number>		A maintenance part will need to be replaced soon.	Note the error number and contact EPSON.

## Error messages (continued)

Message	Light	Explanation	Response
PAPER JAM	<b>Paper Out</b> light flashing	Paper has jammed in the printer.	Raise the paper lever and open the lower cover if necessary. Then remove the jammed paper, close the lower cover, and lower the lever. Turn the printer off and then back on.
PAPER NOT STRAIGHT	<b>Paper Out</b> light on	Paper was fed at an angle.	Reload paper, making sure the edges are straight and lined up with the row of holes.
SERVICE REQ. <error number>	All lights flashing	An error has occurred.	Note the error number, and turn the printer off and then on. If the message remains, contact EPSON.
TURN PRINTER PWR OFF AND THEN ON		This message appears after you clear a paper jam.	Turn the printer off and then on again.

## Where To Get Help

Place your EPSON Preferred<sup>SM</sup>  
Unit ID label here

Service	Access
Telephone support	Call (888) 377-6611. Make sure you have your Unit ID number.  If you experience any difficulty with the toll-free number or your Unit ID number, call (562) 276-1305.
World Wide Web	Go to <a href="http://support.epson.com">http://support.epson.com</a> to download drivers, access product documentation and troubleshooting, and get technical advice through e-mail.
Support for non-EPSON RIP	Contact the RIP manufacturer.

EPSON and EPSON Stylus are registered trademarks of SEIKO EPSON CORPORATION. EPSON UltraChrome and EPSON Photographic Dye are trademarks and EPSON Preferred is a service mark of Epson America, Inc.

Copyright © 2003 by Epson America, Inc.

6/03

# EPSON Stylus® Pro 7600/9600

Printed in USA  
CPD-14020R1